











Ljusdiod färger	LED light colour	Förkortning Abbreviation
Blå	Blue	B
Grön	Green	G
Röd	Red	R
Vit	White	W
Varm vit	Warm white	WW

Armaturfärger	Colours of housing	
Aluminium	Aluminum	A
Krom	Chrome	C
Polerad mässing	Polished brass	B
Satäng nickel	Satin nickel	N
Stål	Steel	S
Svart	Black	K
Rostfritt stål	Stainless steel	Z
Vit	White	W

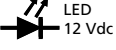
Material	Material	
Aluminium	Aluminum	A
Glas	Glass	G
Plast	Plastic	P
Stål	Steel	S
Rostfritt stål	Stainless steel	SS

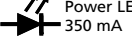
Symboler	Symbols	
Beröringsbar	Touchable	
CE-märkning	CE-mark	
Inomhusbruk	In house use	
Kan monteras på normal brännbar yta	Mounting on normally flammable surface	
Kan monteras på möbler eller i skåp	Mounting on or in furniture or cabinet	
Seriekoppling	Series connection	
Konstantspännings LED 12 Vdc	Constant voltage LED 12 Vdc	
Klass III	Class III	
Konstantströms LED 350 mA	Constant current LED 350 mA	
Parallell	Parallel connection	

Monterings- sätt *Mounting alternative*

A Helt infälld *Fully recessed*



B Halvinfälld *Semi-recessed*



C Utanpåliggande *Surface mounted*



CR Utanpåliggande rund *Surface mounted round*

CS Utanpåliggande fyrkant *Surface mounted square*

CP Utanpåliggande profil *Surface mounted profile*

D Hållare *Bracket with screw*

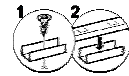

E Vägghmontering *Mounted on wall-side*

F Montering i väggdosa *Mounting in recessed wall box*

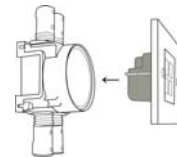

Så här tyder du våra artikelnummer

Exempel: **V-01 C 11 A 15 A W**



- V-01** är Vadsbos beteckning
- C** eller **V** – Constant current eller -voltage
- Effekten** i watt, tex. 11 för 1,1W
- Monteringsätt**, tex **A** (helt infälld)
- Inbyggnads djup**, anges i millimeter, tex. 15 mm
- Armaturfärger**, tex. **A** (aluminium)
- LED-Färg** tex. **W** (vit)